

LAKE NATION

Living on Campus

Be close to it all!

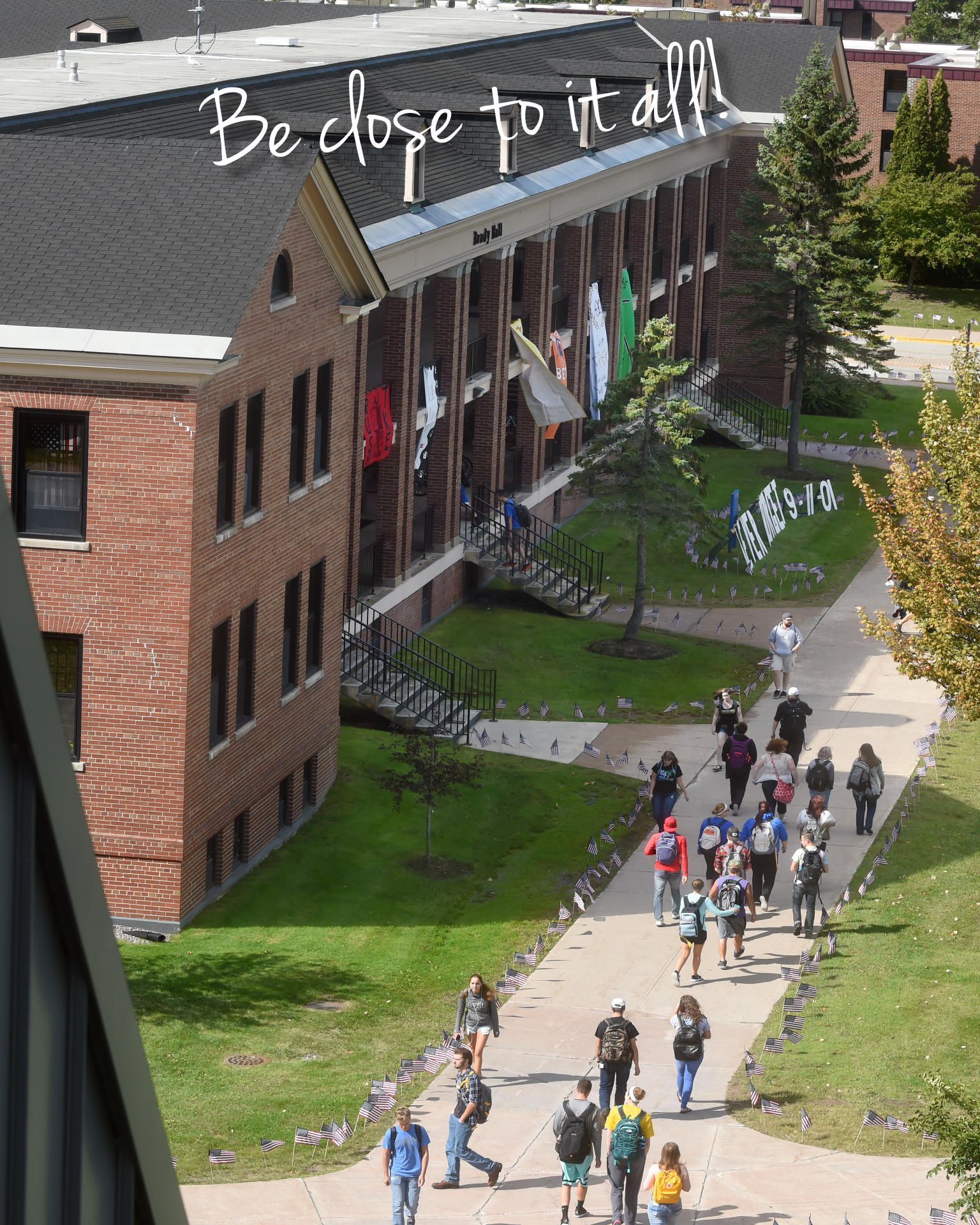



Living on Campus

All housing on LSSU's campus is within a five-minute walk of your classes. In fact, all facilities, including the dining hall, library, Student Activity Center, Health Care Center and Barnes & Noble store are on campus grounds and easily accessible.

Students are required to live on campus if they are less than 27 months out of high school, (freshman and sophomore) unless they apply for a housing exception or live within the tri-counties (Chippewa, Luce, Mackinac).



If you plan on living on campus, you should:

- ✓ Complete the **Housing Application*** online or by paper, and return it to the Campus Life and Housing Office. Priority is given based on the date that the application and payment are received, along with space availability. We strive to accommodate all requests.

The **Residence Hall/Dining Contract** will be available online once we have processed your University Housing Assignment.

- ✓ Find out what to bring to campus by visiting lssu.edu/housing/what-to-bring-to-campus



**Living Learning Communities require an additional application. Contact the Campus Life and Housing Office to get an application or go to our housing website at lssu.edu/housing/applications-handbooks.*

 **LAKE SUPERIOR**
STATE UNIVERSITY

LSSU.EDU/HOUSING

You'll have a support system!



Laker Success

We want every student to succeed in their academic pursuits and have a positive university experience.

Many studies show that students who live in University housing complete more credit hours and have higher GPAs. Access to the library and other academic buildings is more convenient for students living on campus. For these reasons, we encourage students to live in University housing. Eating healthy, exercising, getting

enough sleep, as well as scheduling study and coursework times are all a part of planning for a successful semester.

We are here to help you succeed! LSSU created the Laker Success program to provide academic support inside the residence halls. Our Resident Success Coaches are upper-class students who take an active roll in passing on the skill and techniques that they have developed to students living on campus.

Housing Options

FRESHMAN

OSBORN HALL

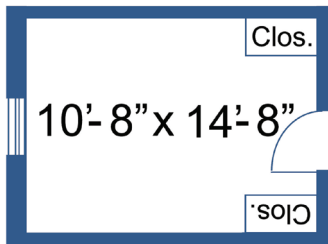

BRADY HALL

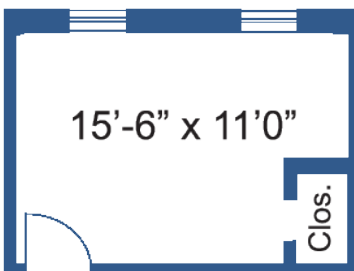
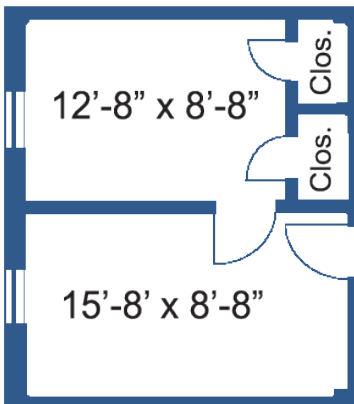

OSBORN HALL

Residence hall for freshmen and limited availability to upper-class men and women. Home to as many as 221 students.

Includes: The Aquarium (student-named study lounge), mailboxes, two laundry rooms, kitchen, and two TV lounges. There are also 24 smaller lounges located throughout the floors and hallways. Bathrooms are community by building and are cleaned and maintained by custodial staff daily.

BRADY HALL

Men's residence hall for freshmen with a maximum capacity of 176. Two-person and four-person rooms available.

Includes: The Shark Tank (student-named study lounge), mailboxes, laundry room, kitchen, game-cleaning room for sportsmen, and recreation room. Bathrooms are community by building, and are cleaned and maintained by custodial staff daily.

Housing Options

SOPHOMORE

THE VILLAGE

Open to students out of high school more than 15 months (traditional sophomores and above). Houses a total of 264 students. This is a suite-style floor plan and has 36 suites consisting of four bedrooms. Each bedroom is designed for double occupancy and each suite has a commons area and a bathroom.

Includes: The Club House (student-named study lounge), mailboxes, and a kitchen.

JUNIOR AND SENIOR

APARTMENTS

Open to students out of high school more than 27 months (traditional juniors and seniors). The complex is comprised of one, two, and three bedroom apartments. Each bedroom is designed for double occupancy, with private rooms granted based on availability.

TOWNHOUSES

Open to students out of high school more than 27 months (traditional juniors and seniors). Consists of 30 units containing two bedrooms and one bath each. Each unit houses four students.

LIVING LEARNING COMMUNITIES (LLC)*

Preference is given to students who have lived on campus for at least one year. Allow students with similar academic interests or career goals to live and study together in a community.

At LSSU, Living Learning Communities (LLC) are housed in the Row Houses, and provide a smaller, more intimate environment. Each of the programs are associated with an academic department or organization. Every LLC also has a faculty or staff member dedicated to the program.

**There is an additional application for this housing available by contacting the Campus Life and Housing Office.*

LSSU.EDU/HOUSING

THE VILLAGE

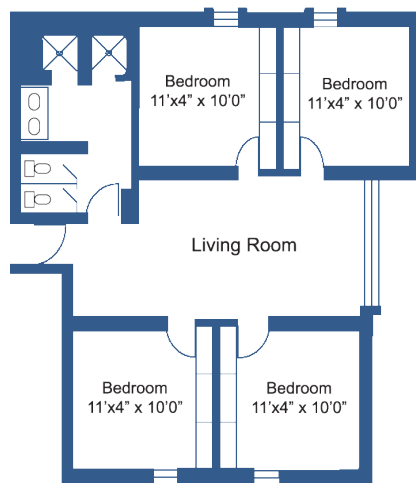

APARTMENT

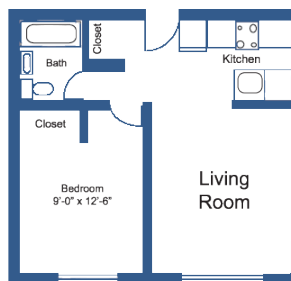

TOWNHOUSES

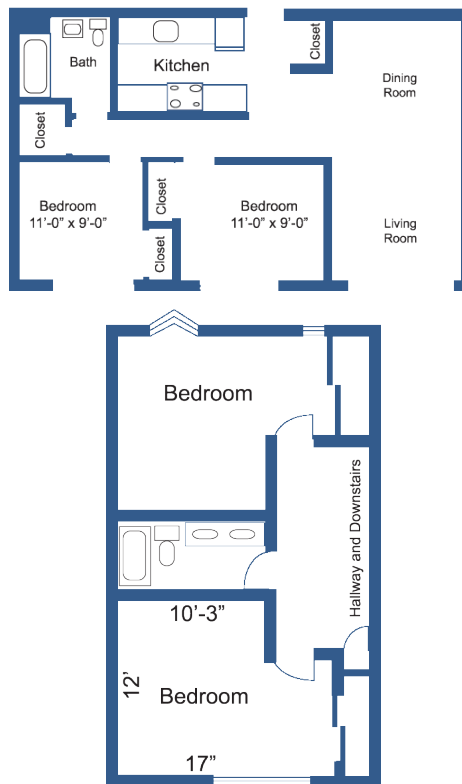



Dining Options

LSSU makes your dining experience the best it can be by providing delicious, healthy and nutritious food in a relaxed atmosphere. Our dining services specializes in meeting a variety of dietary needs.

The Quarterdeck Dining Hall is an all-you-can eat cafeteria. **The Galley** features breakfast, lunch, and dinner entrees, as well as a variety of snacks and beverages. It is a great place to get a snack between classes.

Knot's Café Plus, located in Considine Hall, features a deli-style menu, breakfast items, and a variety of beverages.

There's also a **Starbucks**, and an additional café across campus to provide you with more options.



MEAL PLANS
[lssu.sodexomyway.com/
my-meal-plan](https://lssu.sodexomyway.com/my-meal-plan)





LAKE SUPERIOR STATE UNIVERSITY

650 W. EASTERDAY AVE.
SAULT STE. MARIE, MI 49783

LSSU.EDU/HOUSING



[LSSUCampusLife](#)

